



MOVE INN ESTATES

MAKING THE RIGHT MOVE



Comer Crescent

, Southall, UB2 4XD

Asking Price £210,000



Floor Plan

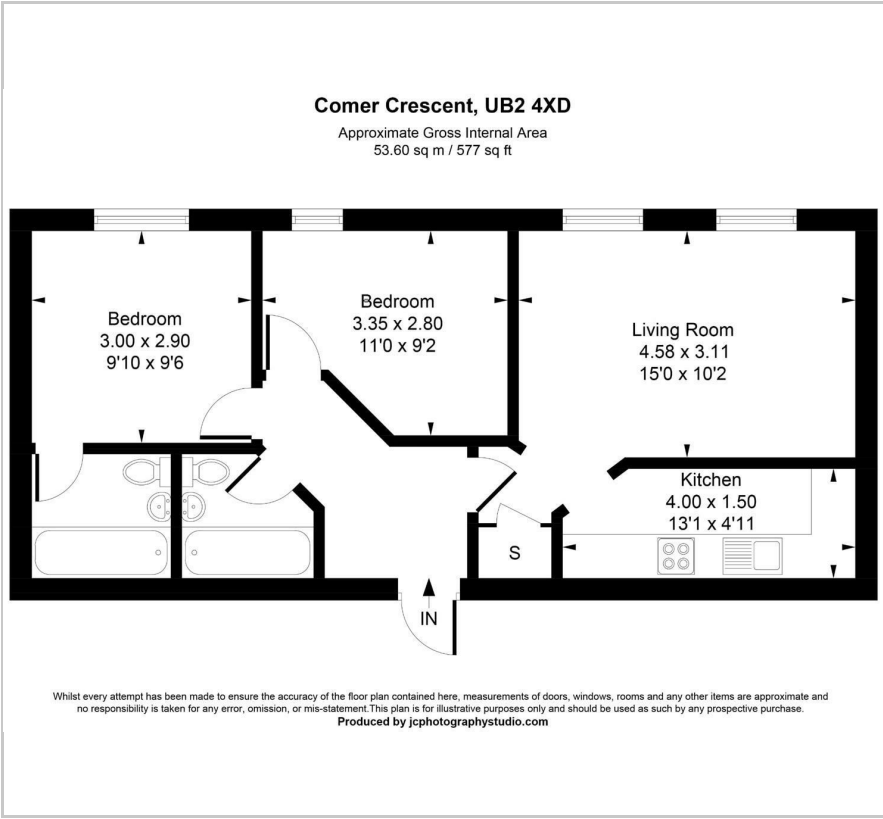

Area Map



Energy Efficiency Graph

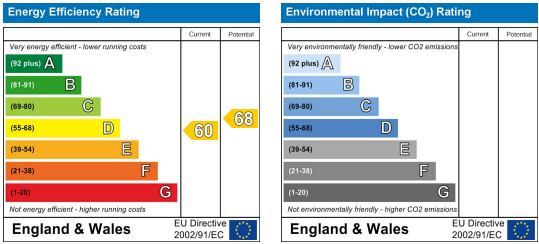

Viewing

Please contact our Move Inn Estates - Sales Office on 0208 574 4966 if you wish to arrange a viewing appointment for this property or require further information.

- Located on a quiet residential area in a well-established neighbourhood
- Spacious Living Spaces
- Light filled space throughout the flat
- Nearby schools within easy reach
- Excellent transport links available
- Close to local shops and everyday amenities
- Ensuite within master bedroom
- Allocated parked
- Easy access to Central London and surrounding areas
- Situated behind Ealing Hospital

Located on a quiet residential crescent in Southall, 15 Comer Crescent is a well-presented 2 bedroom first-floor flat with one allocated parking space, offering comfortable living within a well-established neighbourhood. The property benefits from a convenient location close to a range of local amenities, including shops, schools, and everyday services. Excellent transport links are easily accessible, with nearby bus routes and rail connections providing straightforward access to Central London and surrounding areas. The area is popular with both professionals and small families, offering a balanced residential setting with good connectivity. This property represents an attractive opportunity for those seeking a well-located flat in a thriving West London community.

Leasehold and ground rent details to be confirmed



These particulars, whilst believed to be accurate are set out as a general outline only for guidance and do not constitute any part of an offer or contract. Intending purchasers should not rely on them as statements of representation of fact, but must satisfy themselves by inspection or otherwise as to their accuracy. No person in this firm's employment has the authority to make or give any representation or warranty in respect of the property.